



Getting Started

(V1.5)



ultraLba

Install

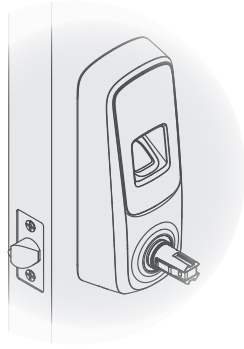

Follow the instructions in the installation guide to install your new UltraLoq UL3 BT Smart Lock.

Download



Download the UltraLoq APP and create a user profile.

Connect

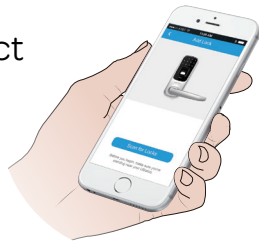

Follow the instructions in the APP to connect your UltraLoq Smart Lock with your Bluetooth enabled smart phone.

Use



Operate your UltraLoq Smart Lock from the APP.

Need Help?

For technical documents and more
Please visit www.u-tec.com/support
Tel: 844-HEY-UTEC (844-439-8832)
Email: support@u-tec.com