

**NEW!**  
more on  
reverse

# Plastic Recessed TV Box™ with Angled Openings

*For use with close-clearance TV mounting hardware*



TVB713  
Multiple gang  
combination  
power/low voltage boxes



TVB713



*Install this tray to hide a digital converter behind the TV*



*In old work, box is a template for the opening*

TVB712

*Tabs, for 1/2" thick drywall, position box properly on stud in new work*



Patent pending

Arlington's plastic recessed combination power and low voltage TV BOX™ offers the secure, easy way to mount flatscreen TVs flush against a wall.

Designed for new or old work, our TVB712 and TVB713 boxes have angled outlet boxes that take convenience to a new level.

The versatile TVB712 ▶ offers power and/or low voltage.



Our larger TVB713 has two angled outlet boxes that keep plugs behind the wall surface – and allow for the use of the new close-clearance TV mounting hardware. *Now you really can mount a TV flush against a wall.*

TVB713 has power and low voltage openings for video, audio and other datacom connections. It also includes a separate, interchangeable tray that you can use to hide the digital converter box, supplied by some cable companies, behind the TV.

- Non-metallic, paintable trim plate
- For new or old work
  - Positioning tabs for 1/2" wall thickness assure accurate placement on stud in new construction
  - For retrofit, use enclosure (without the trim plate) as a template for the wall opening
- Optional cover available for TVB713
- Available with ground clip for use in Canada



Scan QR code for more info.



**Arlington**

1 Stauffer Industrial Park  
Scranton, PA 18517  
**800/233.4717**  
**Fax 570/562.0646**  
**www.aifittings.com**

# Plastic TV Box™ with Angled Openings



## Non-metallic recessed power/low voltage combination box

### OLD WORK Installation



1 Cut hole next to stud using enclosure - without trim plate - as a template. Pull wires. Insert box in hole.



2 Use #6 screws to attach assembled enclosure w/ trim ring to stud through slotted holes in the side walls.



3 Install enclosure assembly to wall with outer screws.



4 Install devices. (L) Two low voltage, one power (illus).

### NEW Construction



1 Attach box to stud through slotted holes. Use minimum of (2) #6 x 1-5/8" wood screws.



2 Pull power and low voltage wire. After installation of wall, continue with OLD WORK steps 3 and 4.



3 Make connections...done!

### INTERCHANGEABLE TRAY OPTION for OLD or NEW WORK

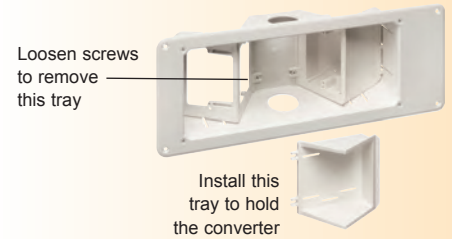

Digital converter installed; plugged in.

CATALOG NUMBER	UPC/DCI/NAED MFG #01 8997	DESCRIPTION	UNIT PKG	STD PKG
TVB712	09712	Recessed Box with Angled Openings Power and/or low voltage	1	1
TVB712GC	09714	Power and/or low voltage w/ ground clip	1	1
TVB713	09713	Power and multiple low voltage openings w/ interchangeable tray	1	1
TVB713GC	09715	Power and multiple low voltage openings w/ interchangeable tray - Includes ground clip	1	1
TVB613C	09631	Non-metallic, blank cover for TVB713	5	5

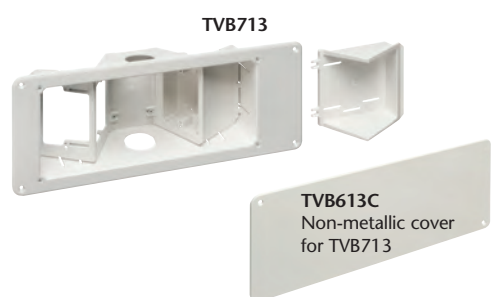

Distributed by



**Arlington**  
1 Stauffer Industrial Park  
Scranton, PA 18517  
800/233.4717  
Fax 570/562.0646  
www.aifittings.com

Patent pending  
TVB713 0511/25M

Scan QR code for more info.

