

# Ecolink ZWAVE Plus Smart Switch Lighting Control Installation Tips.



A Universal Electronics Company

Choose the right Ecolink Smart Switch base on your light switch design. Single and double options available for toggle or rocker style 110V light switches.

**ROCKER STYLE SWITCHES**

**POWER**

- 2 x AA Alkaline Batteries
- Up to 1 year battery life

**DIMENSIONS**

- Height: 76.2mm (3.00in)
- Width: 127mm (5.00in)
- Depth: 19mm (0.75 in)

**PACKAGING**

- Single Gang: 60 /carton
- Double Gang: 30/carton

**CERTIFICATIONS**

- FCC and IC Approved

**WARRANTY**

- 12 Months

Single Gang: **SDLS2-ZWAVE5**      Double Gang: **DDL2-ZWAVE5**

**TOGGLE STYLE SWITCHES**

**POWER**

- 2 x AA Alkaline Batteries
- Up to 1 year battery life

**DIMENSIONS**

- Height: 76.2mm (3.00in)
- Width: 127mm (5.00in)
- Depth: 19mm (0.75 in)

**PACKAGING**

- Single Gang: 60 /carton
- Double Gang: 30/carton

**CERTIFICATIONS**

- FCC and IC Approved

**WARRANTY**

- 12 Months

Single Gang: **STLS2-ZWAVE5**      Double Gang: **DTLS2-ZWAVE5**

- Smart Switch options will not work properly on 110V light switch banks larger than double switch.
- \*\* Verify HUB/Controller compatibility before purchasing. (See List)

# Smart Switch Installation

- Before purchasing the Smart Switch, verify HUB/controller compatibility. (See List)

## SIMPLE 10 MINUTE INSTALLATION PROCESS

### STEP 1



Remove visible screws and take off the switch plate.

### STEP 2

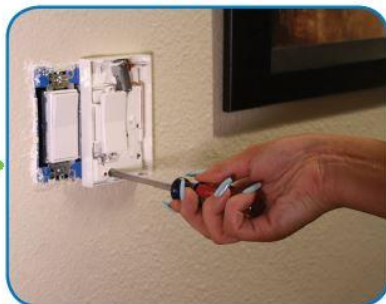

Add Ecolink mechanical light switch over the light switch and replace screws removed.

### STEP 3



After adjusting placement of both mechanical switch overlays, install the batteries.

### STEP 4



Pair Z-Wave switch to control your hub.

### STEP 5



Add cover and test.

### STEP 6



The Ecolink Light Switch is now connected to your Z-Wave compatible app and system.

# Toggle Style Ecolink Smart Switch Installation

- Before purchasing the Smart Switch, verify HUB/controller compatibility. (See List)
- Do not attempt to test Smart Switch when it is not attached to an actual light switch. This will cause it to lock up and fail to operate.

**Step 1** – Remove light switch plate. (Save plate screws.)



**Step 2** - Mount Toggle Style Ecolink Smart Switch

- Ensure switch toggle is inserted in up/ down control mechanism.
- Use plate screws to secure Smart Switch.



**Step 3** – Power up Ecolink Smart Switch

- Insert 2 “AA” batteries. Red light flashing indicates proper power.
- NOTE: For dual switches, ensure “on” position switch is in the up position.



**Step 4** – Add Ecolink Smart Switch to Z-Wave Plus network.

- Verify compatibility with your HUB/controller. (See List)
- Put HUB/controller into “add” or “Inclusion” mode. (see their manual for process)
- Select proper device association in menu. (See List)
  - For SmartThings app version 1.6.27-223 choose Ecolink brand for selection
- Press inclusion/exclusion button on Ecolink Smart Switch.
- HUB/controller will provide indication of successful inclusion/exclusion.



**Step 5** – Add Smart Switch covers and test manual and automatic operation.

*\* Review installation instructions for full details on Ecolink Smart Switch operations.*

*\*\* Some 110V light switch toggles may be mounted crooked or deep in box. Some adjustment of light switch may be required to ensure smooth operation of Smart Switch and extended battery life. If smart switch appears to be grinding during trigger, or does not operate 110V light switch, try adjusting light switch in box.*

# Rocker Style Ecolink Smart Switch Installation

- Before purchasing the Smart Switch, verify HUB/controller compatibility. (See List)
- Do not attempt to test Smart Switch when it is not attached to an actual light switch. This will cause it to lock up and fail to operate.



**Step 1** – Remove light switch plate. (Save plate screws.)

**Step 2** - Mount Toggle Style Ecolink Smart Switch

- Ensure switch toggle is inserted in up/ down control mechanism.
- Use plate screws to secure Smart Switch.



**Step 3** – Power up Ecolink Smart Switch

- Insert 2 “AA” batteries. Red light flashing indicates proper power.
- NOTE: For dual switches, ensure “on” position switch is in the up position.



**Step 4** – Add Ecolink Smart Switch to Z-Wave Plus network.

- Verify compatibility with your HUB/controller. (See List)
- Put HUB/controller into “add” or “Inclusion” mode. (*see their manual for process*)
- Select proper device association in menu. (See List)
  - *For SmartThings app version 1.6.27-223 choose Ecolink brand for selection*
- Press inclusion/exclusion button on Ecolink Smart Switch.
- HUB/controller will provide indication of successful inclusion/exclusion.



**Step 5** – Add Smart Switch covers and test manual and automatic operation. If Smart Switch is grinding or does not operate 110V light switch, use rocker adjustment screws to create smooth operation.

*\* Review installation instructions for full details on Ecolink Smart Switch operations.*

*\*\* Some 110V light switch rockers may be mounted crooked or deep in box. Some adjustment of light switch may be required to ensure smooth operation of Smart Switch and extended battery life.*

# Ecolink Smart Switch HUB/Controller Compatibility



## Ecolink Tested Compatibility Listing

Ecolink Device	HUB/Controller	Add Menu	Operation Notes
<i>Ecolink Smart Switch</i>	Samsung SmartThings V1	Generic - ZWAVE Switch	Will not display battery power level
	Samsung SmartThings V2	Generic - ZWAVE Switch	Will not display battery power level
	Samsung SmartThings V3	Ecolink Brand - Switch/Dimmer	Works properly. Includes battery power level
	Vera Plus	No info Available	Works properly. Includes battery power level
	Vera Edge	Generic ZWAVE Light Switch add	Works properly. Includes battery power level.
	Vera Lite	Generic ZWAVE Light Switch add	Works properly. Includes battery power level
	HomeSeer	No info Available	Works properly. Includes battery power level.

\* The above HUB/controllers are factory tested and operate properly with the Ecolink Smart Switch. Ecolink cannot guarantee that other ZWAVE Plus capable systems will work properly.