

## Decora Smart with Z-Wave Plus Technology



### Complete Solution for Your Hub

The Decora Smart with Z-Wave Plus Technology family of products feature six devices including in-wall dimmers, a switch, receptacle, fan speed controller, and plug-in modules. The newest devices, the ZW4SF and ZW15R, utilize the latest 700 Series Chip generation of technology for advanced wireless lighting control products with features like S2 security and SmartStart.



Leviton devices support a wide range of load types including LED, CFL, and incandescent amongst others at various wattages with multi-way capability for large rooms or hallways. The products are Z-Wave Plus certified, ensuring increased communication range, network wide inclusion, and over the air updates.

The highly advanced design features two-way feedback, is scene capable, and is supported by security systems, hubs, and gateways that are Z-Wave enabled which provide remote access and scheduling.

In-Wall devices and switches feature true rocker action, pressing the top to turn on and the bottom to turn off. For dimmers and fan speed controllers, the dim/brighten bar is conveniently located along the right hand side of the paddle, ensuring ease of use with the state-of-the-art device. Vanishing LEDs to the left of the paddle show current and target level with real-time feedback. To meet any decor, color change kits are available in white, ivory, light almond, gray, black, and brown. For the most professional and cleanest installation, pair the device with an optional Leviton screwless wallplate.



# Features and Benefits

- Gloss finish complements any décor
- Remotes available for 3-way/multi-location control
- Limited 5-Year Warranty: DZ6HD, DZ15S, DZPA1, DZPD3
- Limited 2-Year Warranty: ZW15R, ZW4SF

## Z-WAVE PLUS CERTIFICATION

- Increased communication range
- Network Wide Inclusion
- Support for beaming and secure commands
- Over The Air (OTA) updates
- S2 Security and SmartStart: ZW15R, ZW4SF

### DZ6HD 600W Dimmer with Z-Wave Technology

#### SINGLE POLE WIRING DIAGRAM

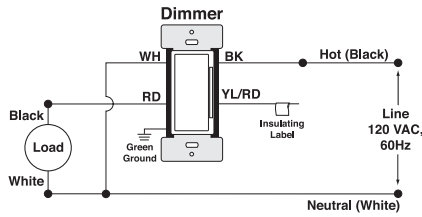

#### THREE-WAY WIRING DIAGRAM

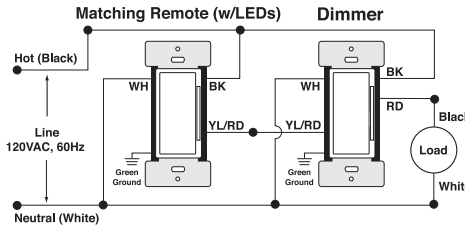

#### Agency Standing and Compliance

- Complies with UL 1472
- CSA Certified (File #003413)
- NOM-ANCE Certified
- Complies with FCC Part 15, Class B
- Z-Wave Plus Certified

### DZ15S Switch with Z-Wave Technology

#### SINGLE POLE WIRING DIAGRAM

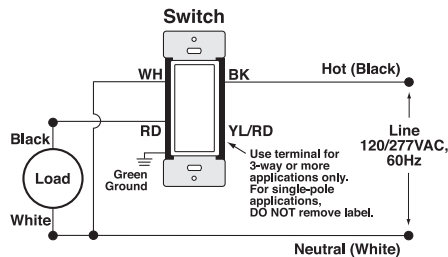

#### THREE-WAY WIRING DIAGRAM

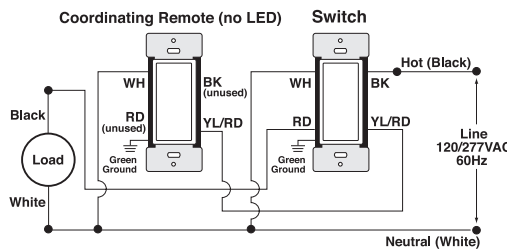

#### Agency Standing and Compliance

- Complies with UL 917
- CSA Certified (File #003413)
- NOM-ANCE Certified
- Complies with FCC Part 15, Class B
- Z-Wave Plus Certified

### ZW15R – Decora Smart Tamper-Resistant Outlet with Z-Wave Technology

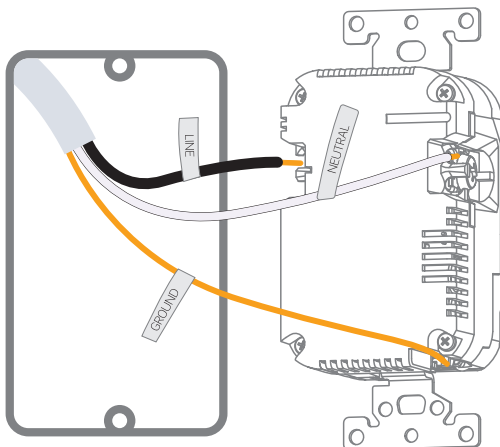

#### Agency Standing and Compliance

- Z-Wave Plus Certified
- cULus Listed, Energy Mgmt Equip. 9D34
- NOM (Mexico)
- Complies with FCC Part 15, Class B
- FCC ID: QGH-ZW15R
- IC: 2473A-ZW15R

## ZW4SF - Decora Smart 4 Speed Fan Controller with Z-Wave Technology

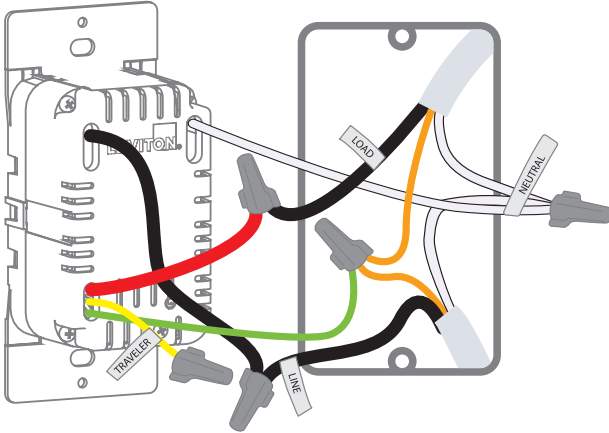

### Agency Standing and Compliance

- Z-Wave Plus Certified
- cULus Listed, Energy Mgmt Equip. 9D34
- NOM (Mexico)
- Complies with FCC Part 15, Class B
- FCC ID: QGH-ZW4SF
- IC: 2473A-ZW4SF

## DZPA1 Plug-in Outlet with Z-Wave Technology

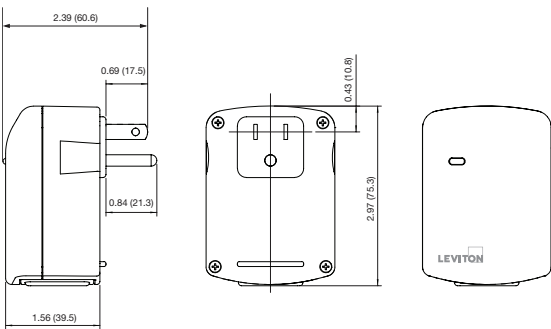

### Agency Standing and Compliance

- Complies with UL 917
- CSA Certified (File #003413)
- NOM-ANCE Certified
- Z-Wave Plus Certified
- Complies with FCC Part 15, Class B

## DZPD3 Plug-in Dimmer with Z-Wave Technology

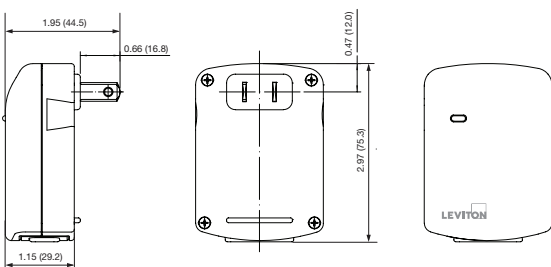

### Agency Standing and Compliance

- Complies with UL 1472
- CSA Certified (File #003413)
- NOM-ANCE Certified
- Z-Wave Plus Certified
- Complies with FCC Part 15, Class B

## Ordering Information

Description	Cat. No.
Decora Smart 600W Dimmer with Z-Wave Technology	DZ6HD-1BZ
Decora Smart 15A Switch with Z-Wave Technology	DZ15S-1BZ
Decora Smart Tamper-Resistant Outlet with Z-Wave Technology	ZW15R-1BW
Decora Smart 4 Speed Fan Controller with Z-Wave Technology	ZW4SF-1BW
Decora Smart Plug-in Outlet with Z-Wave Technology	DZPA1-2BW
Decora Smart Plug-in Dimmer with Z-Wave Technology	DZPD3-2BW
Decora Smart Matching Dimmer (for Multi-Location)	DD00R-DLZ
Decora Smart Matching Switch (for Multi-Location)	DD0SR-DLZ

### Leviton Manufacturing Co., Inc. Global Headquarters

201 North Service Road, Melville, NY 11747-3138  
Tel: 1-800-323-8920 Fax: 1-800-832-9538  
Tech Line: (8:30AM-7:00PM ET Monday-Friday): 1-800-824-3005

### Leviton Manufacturing Co., Inc. Residential

865 Fulton St., Suite 500, New Orleans, Louisiana, 70130  
Tel: 1-504-608-9001

Visit our website at: [leviton.com/decorasmart](http://leviton.com/decorasmart)

©2020 Leviton Manufacturing Co., Inc. All rights reserved.

