



Make your hot water last longer while cleverly saving thousands of gallons a year.

With ShowerStart TSV technology you'll say good bye to all the little things that bother you about your family's shower routines and hot water usage. Installation is about as easy as changing a lightbulb, doesn't lower shower head pressure or flow and saves thousands of gallons of water, as well as the energy used to heat it - year, after year, after year.

ShowerStart® TSV



Not low flow.

ShowerStart TSV supports high volume flows (4-6 gpm) and won't interfere with the pressure, flow or feel while you're showering. Simply attach this nifty technology to the shower head that's right for you.



More hot water for you.

About a minute's worth of hot water is accidentally wasted every time you start your shower. Save it and you'll have more hot water when you need it most.



Freedom while you wait.

Mornings are better when you don't have to choose between wasting your time or wasting your hot water. Now you can brush your teeth, shave or pick out the perfect outfit ... and your shower will just wait for you.



Alerts you when your shower is ready.

The first time you hear your shower slow to a trickle you'll feel the freedom of knowing your shower is warm and waiting.



No more empty showers running endlessly.

Frustrated with family members letting the shower run on and on while doing something else? Stop it when it's hot and save gallons of water every time they shower.



How ShowerStart TSV Works

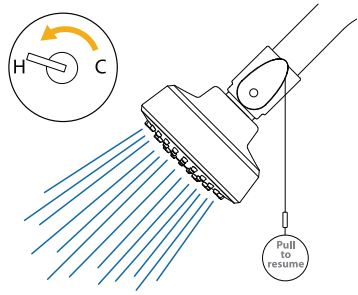

1 Turn on shower. cold water exits...

Continue with your typical routine - the things you do while waiting for the shower to become warm.

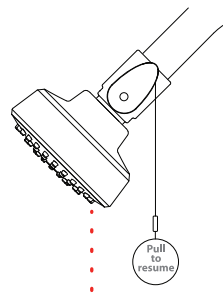

2 ShowerStart® kicks in.

When the water reaches 95°F, ShowerStart automatically lowers the flow to a trickle - saving hot water until you're ready to get in.

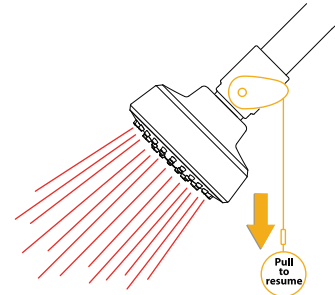

3 Ready when you are.

You know your shower is warm, so pull the cord to resume full flow and begin showering.

Physical Characteristics

- Solid brass construction
- Chrome plated
- Integrated screen filter
- Length: 2" (51 mm)
- Width 1.81" (46 mm)
- Weight: 5.9 oz (.17 kg)
- 12" (30.5 cm) Detachable lanyard
- ½" NPT fittings (female inlet / male outlet)
- Designed for use in environments with static water pressures of 30 psi or higher
- Automatically resets for next use



Specified Model

MODEL	DESCRIPTION	FINISH
SS-1002CP-SB	ShowerStart TSV; single shipper box	chrome polish
SS-1002CP-BP	ShowerStart TSV; 48 unit bulk pack	chrome polish

©2018 Evolve Technologies LLC. All rights reserved.
 Designed and developed in USA. Manufactured in China. Rev-0318
 Patent <http://www.thinkevolve.com/patents>
 Other U.S. and Foreign Patents Pending.

Technical Notes

The ShowerStart TSV is not an anti-scald device:

- Lower water heater to a maximum of 120° F (49° C)
- Always resume water flow and check water temperature before entering shower
- Tankless systems require a minimum flow rate to produce hot water. When this product is used with some tankless systems a brief, yet noticeable, change in the shower's temperature may occur shortly after resuming the shower's normal flow

3 Year Warranty

Codes / Standards

MEETS OR EXCEEDS THE FOLLOWING:

- Uniform Plumbing Codes (UPC): IAPMO IGC 244-2015a



Products:

Hand Shower

+ ShowerStart® TSV

- Integrated Showerstart TSV
- High pressure spray
- High-nozzle-count spray head
- Rub-clean, anti-clog spray nozzles
- Chrome plated finish
- Stainless steel hose
- Mounting bracket
- Various models available
- WaterSense and cUPC certification
- 3 year warranty



Shower Head

+ ShowerStart® TSV

- Integrated ShowerStart TSV
- High pressure spray
- High-nozzle-count spray head
- Rub-clean, anti-clog spray nozzles
- Chrome plated finish
- Various models available
- WaterSense and cUPC certification
- 3 year warranty

Auto-Diverting Tub Spout System

+ ShowerStart® TSV

- Integrated Showerstart TSV
- Reduces warm-up waits by increasing hot water delivery speeds
- Automatically diverts hot water to the showerhead once it arrives
- Anti-leak tub spout design
- Integrated bypasses for bathing
- Includes WaterSense showerhead
- Polished chrome finish
- WaterSense and cUPC certification
- 3 year warranty

